



H & H ENTERPRISES, INC.



ARCHITECTURAL METALS

FOR YOUR **QUALITY**

DECORATIVE METAL NEEDS...

ALUMINUM COMPOSITE PANELS

(ACM)



TABOR CENTER
GRAND ENTRY CAPITALS
ROUT & RETURN ACM
DENVER, CO

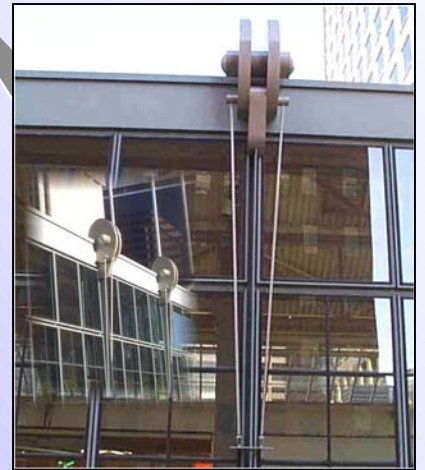

TABOR CENTER
"FEATURES"
CUSTOM ACM PRE-FABRICATION
DENVER, CO



HIGHLANDS RANCH HIGH SCHOOL
DIRECT ADHERED ACM PANELS
HIGHLANDS RANCH, CO



VITESSE SEMICONDUCTOR
ROUT & RETURN ACM PANELS
CURVED DECORATIVE CORNER PANELS
COLORADO SPRINGS, CO



ELDORADO RIDGE III
ROUT & RETURN ACM ENTRY CANOPY
BROOMFIELD, CO



LEPRINO FOODS
PANEL FABRICATION
DENVER, CO



CANYON GATE PLAZA
ROUT & RETURN ACM PANELS
DIRECT ADHERED CURVED ACM MECHANICAL SCREEN
BOULDER, CO

FABRICATION / INSTALLATION

ROUT RETURN WET SEAL

This attachment method uses a tough aluminum extrusion fastened to your plywood substrate. Stainless steel teeth embed in the 7/8" return leg of your panel for a secure concealed fastener look. A rubber wedge is driven between the panel return leg to force the connection of the stainless steel clips. A 1/2" reveal is created with an attractive black wedge that will not leak. The joint can be filled with beauty caulking (by others) if something other than black joints is desired.

ADVANTAGES:

•Appearance

- Concealed Fasteners
- Smooth straight black accent joints

•Versatility

- Can accept either 4mm or 6mm thickness
- Extrusions are field installed prior to panel fabrication

•Strength

- Our extrusion system is min. .063" thick. This means that our extrusion system is stronger than the panel itself.
- Stiffening bars integrate within the extrusion system for larger panels
- Heavy duty stainless steel teeth embed directly into the back 1/3 of your panel for a sure connection.
- Specially designed heavy duty rubber wedge resists movement, therefore it will not slip out of your joint.

•Flexibility

- Our Rout & Return system can accommodate complex designs
- Tapers built into the field of the panel instead of the thin joint. This reduces unsightly joints.

DIRECT ADHESION

This attachment method uses a 1/8" foam tape & Dow industrial grade silicone to directly adhere ACM to your plywood substrate. This method works well for radiused or curved panels.

ADVANTAGES:

•Appearance

- No mechanical fasteners are used

•Versatility

- Excellent for curved or radiused panels.

•Strength

- So strong the plywood will delaminate before the silicone bond is broken.

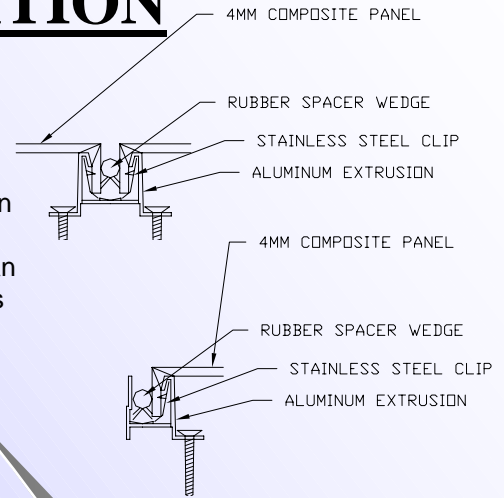

STAPLETON MEDICAL OFFICE BUILDING
ROUT & RETURN ACM
DENVER, CO



SPORTS AUTHORITY
DIRECT ADHERED ACM
LITTLETON, CO

***All of our ACM is fabricated
by CNC Router.***



H & H ENTERPRISES, INC.



ARCHITECTURAL METALS

Since 1980

12520 GRANT DRIVE SUITE #100
THORNTON, CO 80241-2406
PHONE: (303) 429-4847
FAX: (303) 429-0826
E-MAIL: info@h-hmetals.com
Website: www.h-hmetals.com